

The image features a large, detailed view of a complex ceramic feedthrough assembly on the left, with multiple ports and a flange. On the right, three smaller, glowing components are shown: a multi-pin connector, a two-pin connector, and a single-pin connector. The background is dark with vibrant, swirling red and orange light trails.

**Ceramaseal**  
A division of **CeramTec**

**FEEDTHROUGH**

## Description

Feedthrough: An assembly which provides for the transfer of electrical power, gases or fluids from outside a hermetic chamber to the inside. Feedthroughs can provide both a hermetic seal and electrical isolation from the chamber wall. Feedthroughs are sometimes referred to as 'passthroughs.'

Ceramaseal feedthroughs provide the solutions for applications requiring hermeticity and electrical isolation. In addition to remaining leak-free in high and ultra-high vacuum, many of Ceramaseal's feedthroughs can accommodate:

- High temperatures
- Cryogenic temperatures
- High pressure
- Aggressive chemicals

A feedthrough is basically defined by the requirements for installation, insulation, and conductor material. The method of interconnection is flexible and left to the customer's discretion. A selection of push-on contacts can be found in the Accessories section of this catalog. If you require a feedthrough with an interconnection device (plug) refer to the Multipin Connector section of the catalog.

## Standard Specifications

- Voltages to 125 kV
- Current to 1000 Amps
- Up to 41 conductors
- Temperature Range: -269° C to 450° C
- Internal Pressure  $1 \times 10^{-10}$  torr to 3000 psig

www.ceramaseal.com

## Extreme / Custom Design

- Multiple feedthrough flange assemblies
- 940-pin header assembly
- Corona-free designs to 180 kV DC
- Currents in excess of 2,500 Amps
- Pressures to 20,000 psig

## Installation

Standard installation mountings include:

- Braze
- Weld (Pulse-TIG, TIG, Laser, E-Beam)
- ISO KF flange
- ConFlat flange
- NPT fitting (see Pressure section)
- 1" Baseplate (see Baseplate section)

## Applications

A few of the many applications in which these feedthroughs are commonly used are:

- Semiconductor processing equipment
- Particle accelerators
- Furnaces
- Analytical equipment
- In-vacuum coating
- Satellite instrumentation
- X-ray detection equipment

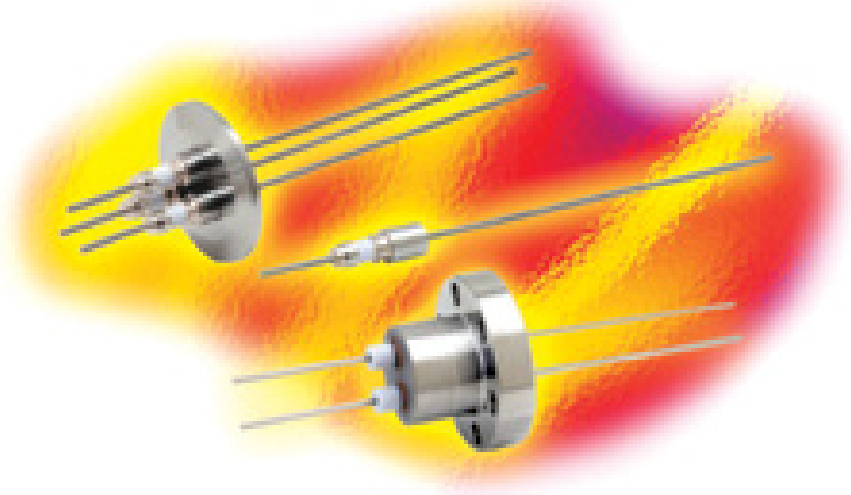







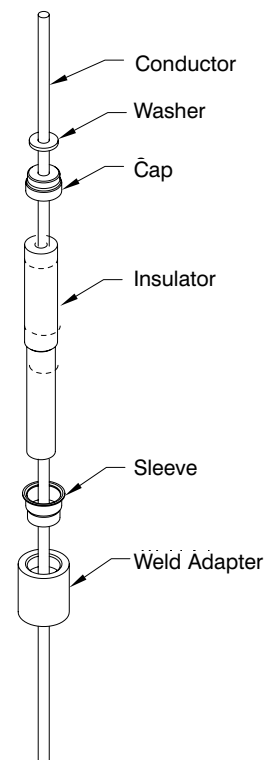

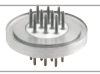

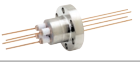

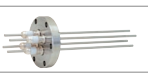
## New Products

- RF Feedthroughs with non-magnetic materials and low coupling effects
- Feedthroughs now available in ISO KF flanges
- New high-density, low current feedthroughs

## Typical Feedthrough Construction

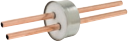

Type	Voltage DC	Current (Amps per conductor)	# of Conductors	Conductor Size (in inches)	Sub-section	Pages
	to 2 kV	to 16 Amps	1 to 8	0.032	Instrumentation / Power	A4 - A8
	1 kV	1 Amp	3 to 41	0.040	Instrumentation / Power	A9 - A11
	500 V	11.5 Amps	1	0.042	Instrumentation / Power	A12
	to 6 kV	to 27 Amps	1 to 4	0.050	Instrumentation / Power	A12 - A19
	to 5 kV	4.8 Amps	4 to 10	0.062	Instrumentation / Power	A19 - A21
	to 20 kV	to 55 Amps	1 to 12	0.094	Instrumentation / Power	A22 - A38
	5 kV	to 100 Amps	1 to 4	0.154	Instrumentation / Power	A39 - A42
	12 kV	to 185 Amps	1 to 4	0.250	Instrumentation / Power	A42 - A46
	8 kV	to 330 Amps	1 to 2	0.375	Instrumentation / Power	A46 - A48
	8 kV	to 470 Amps	1	0.500	Instrumentation / Power	A49 - A50
	8 kV	to 1000 Amps	1	0.750	Instrumentation / Power	A50 - A53
	20 kV	to 185 Amps	1	0.094 or 0.250	High Voltage	A54 - A58
	25 kV	to 55 Amps	3	0.094	High Voltage	A58 - A59
	30 kV	to 55 Amps	1 to 2	0.094	High Voltage	A60 - A62
	50 to 125 kV	to 125 Amps	1	0.156	High Voltage	A63 - A67
	to 14 kV	to 800 Amps	1 to 2	0.25	RF Power-Liquid Cooled	A68 - A72

Feedthrough

Multipin Connector

Coaxial

Thermocouple

Isolator

Viewport

Pressure

Baseplate

Crystal Sensor

Heater

Accessories

www.ceramaseal.com

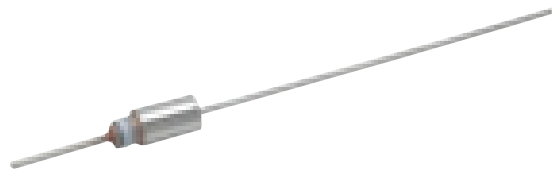

**.032 [0.81] Dia. Conductor**  
 One Conductor  
 Installation: Weld

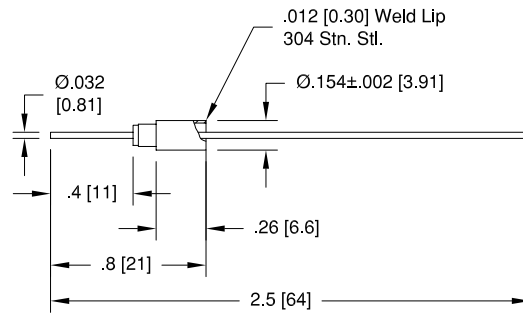

Voltage DC	Conductor		Pressure @ 20 °C		Temperature °C		Magnetic Materials	Ceramaseal Part Number	List Price
	Amps	Material	PSIG	Bar	Min	Max			
1 kV	1.1	304 Stn. Stl.	3500	241	-269	450	No	9297-03-W	\$25
1 kV	5	Nickel	3500	241	-269	450	Yes	9297-01-W	\$25
1 kV	8.5	Molybdenum	3500	241	-269	450	No	9297-06-W	\$25
1 kV	16	Copper	3500	241	-269	450	No	9297-08-W	\$25

For welding instructions see page L23. For lead attachment see pages K14 - K19.

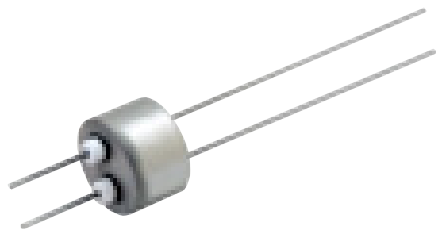

**.032 [0.81] Dia. Conductor**  
 Two Conductors  
 Installation: Weld

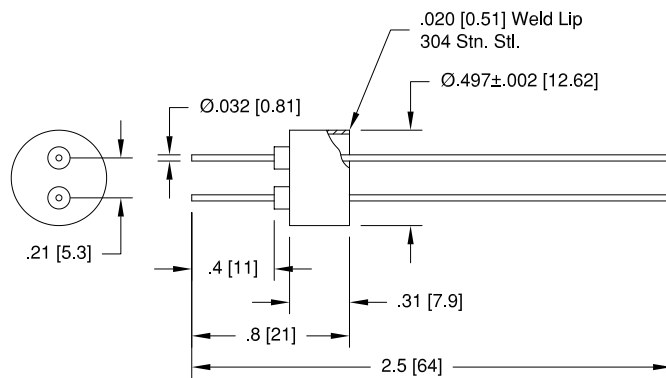

Voltage DC	Conductor		Pressure @ 20 °C		Temperature °C		Magnetic Materials	Ceramaseal Part Number	List Price
	Amps	Material	PSIG	Bar	Min	Max			
2 kV	1.1	304 Stn. Stl.	1400	96	-269	450	No	9298-07-W	\$60
2 kV	5	Nickel	1400	96	-269	450	Yes	9298-01-W	\$60
2 kV	8.5	Molybdenum	1400	96	-269	450	No	9298-05-W	\$60
2 kV	16	Copper	1400	96	-269	450	No	9298-06-W	\$60

For welding instructions see page L23. For lead attachment see pages K14 - K19.

www.ceramaseal.com

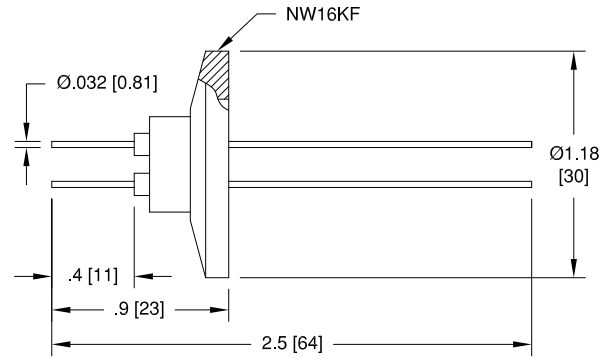
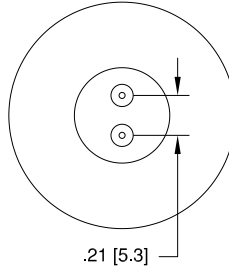
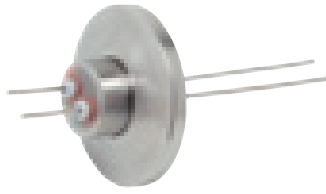

## .032 [0.81] Dia. Conductor

Two Conductors

Installation: NW16KF

Voltage DC	Conductor Amps	Conductor Material	Pressure @ 20°C PSIG*	Pressure @ 20°C Bar*	Temperature °C Min	Temperature °C Max	Magnetic Materials	Ceramaseal Part Number	List Price
2 kV	1.1	304 Stn. Stl.	0	0	-25	205	No	17006-01-KF	\$100
2 kV	5	Nickel	0	0	-25	205	Yes	17006-02-KF	\$100
2 kV	8.5	Molybdenum	0	0	-25	205	No	17006-03-KF	\$100
2 kV	16	Copper	0	0	-25	205	No	17006-04-KF	\$100

For flange assembly instructions see page L26. For lead attachment see pages K14 - K19. \*An overpressure ring is required for internal pressurized use from 5 to 100 psig [0.3 to 7 bar].

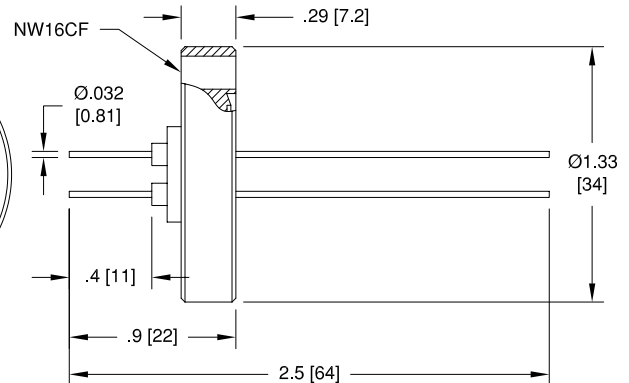
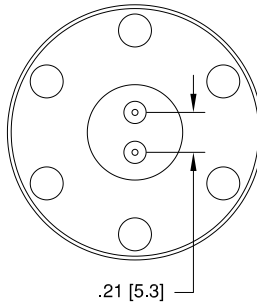
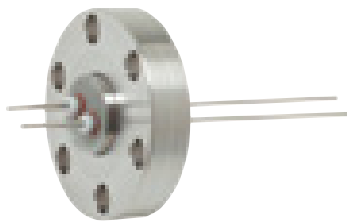

## .032 [0.81] Dia. Conductor

Two Conductors

Installation: 1 1/3" ConFlat (NW16CF)

Voltage DC	Conductor Amps	Conductor Material	Pressure @ 20°C PSIG	Pressure @ 20°C Bar	Temperature °C Min	Temperature °C Max	Magnetic Materials	Ceramaseal Part Number	List Price
2 kV	1.1	304 Stn. Stl.	1400	96	-269	450	No	17046-01-CF	\$100
2 kV	5	Nickel	1400	96	-269	450	Yes	17046-02-CF	\$100
2 kV	8.5	Molybdenum	1400	96	-269	450	No	17046-03-CF	\$100
2 kV	16	Copper	1400	96	-269	450	No	17046-04-CF	\$100

For flange assembly instructions see page L24 - L25. For lead attachment see pages K14 - K19.

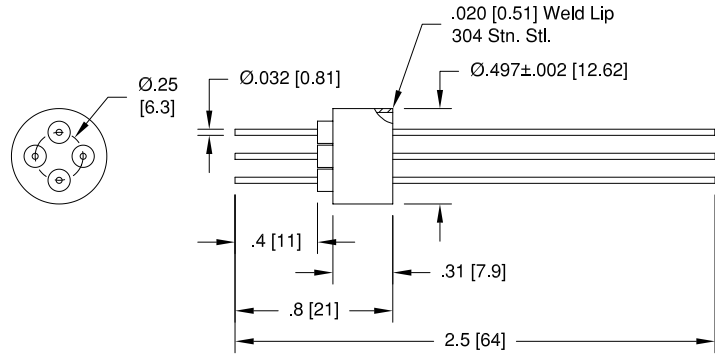
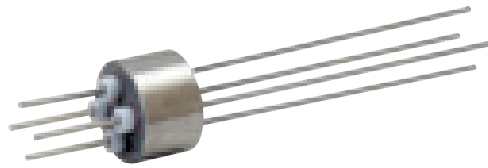

## .032 [0.81] Dia. Conductor

Four Conductors

Installation: Weld

Voltage DC	Conductor		Pressure @ 20 °C		Temperature °C		Magnetic Materials	Ceramaseal Part Number	List Price
	Amps	Material	PSIG	Bar	Min	Max			
2 kV	1.1	304 Stn. Stl.	1400	96	-269	450	No	9299-05-W	\$72
2 kV	5	Nickel	1400	96	-269	450	Yes	9299-01-W	\$72
2 kV	8.5	Molybdenum	1400	96	-269	450	No	9299-04-W	\$72
2 kV	16	Copper	1400	96	-269	450	No	9299-06-W	\$72

For welding instructions see page L23. For lead attachment see pages K14 - K19.

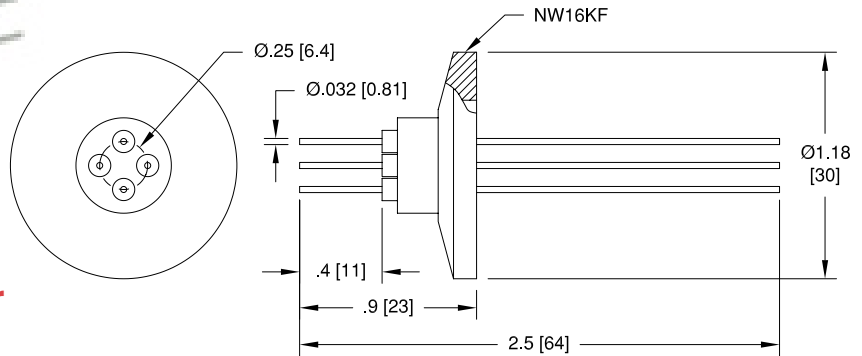
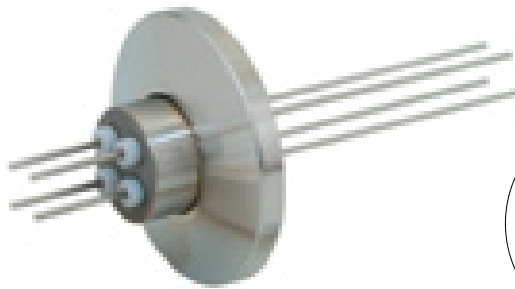

## .032 [0.81] Dia. Conductor

Four Conductors

Installation: NW16KF

Voltage DC	Conductor		Pressure @ 20 °C		Temperature °C		Magnetic Materials	Ceramaseal Part Number	List Price
	Amps	Material	PSIG*	Bar*	Min	Max			
2 kV	1.1	304 Stn. Stl.	0	0	-25	205	No	17007-01-KF	\$112
2 kV	5	Nickel	0	0	-25	205	Yes	17007-02-KF	\$112
2 kV	8.5	Molybdenum	0	0	-25	205	No	17007-03-KF	\$112
2 kV	16	Copper	0	0	-25	205	No	17007-04-KF	\$112

For flange assembly instructions see page L26. For lead attachment see pages K14 - K19. \*An overpressure ring is required for internal pressurized use from 5 to 100 psig [0.3 to 7 bar].

www.ceramaseal.com

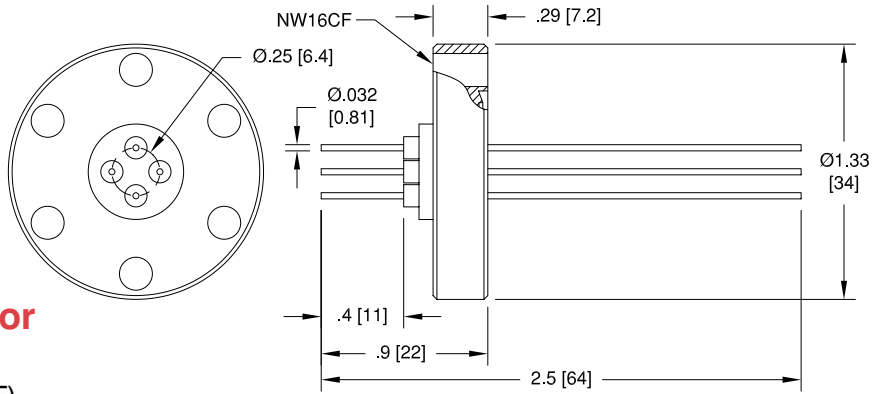
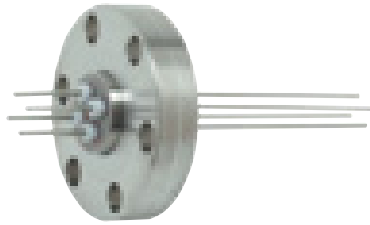

## .032 [0.81] Dia. Conductor

Four Conductors

Installation: 1 1/3" ConFlat (NW16CF)

Voltage DC	Conductor		Pressure @ 20 °C		Temperature °C		Magnetic Materials	Ceramaseal Part Number	List Price
	Amps	Material	PSIG	Bar	Min	Max			
2 kV	1.1	304 Stn. Stl.	1400	96	-269	450	No	17048-01-CF	\$112
2 kV	5	Nickel	1400	96	-269	450	Yes	17048-02-CF	\$112
2 kV	8.5	Molybdenum	1400	96	-269	450	No	17048-03-CF	\$112
2 kV	16	Copper	1400	96	-269	450	No	17048-04-CF	\$112

For flange assembly instructions see page L24 - L25. For lead attachment see pages K14 - K19.

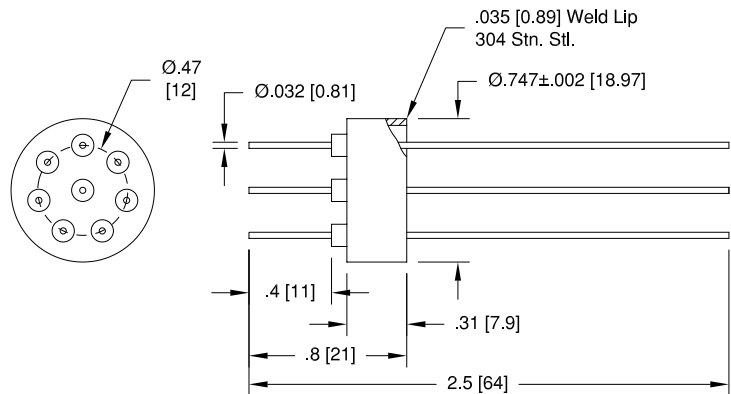
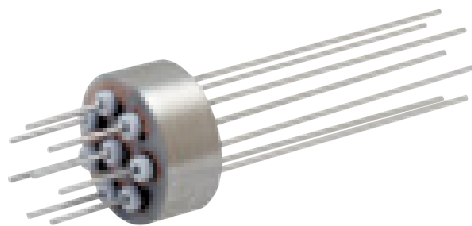

## .032 [0.81] Dia. Conductor

Eight Conductors

Installation: Weld

Voltage DC	Conductor		Pressure @ 20 °C		Temperature °C		Magnetic Materials	Ceramaseal Part Number	List Price
	Amps	Material	PSIG	Bar	Min	Max			
1.5 kV	1.1	304 Stn. Stl.	500	34	-269	450	No	9294-03-W	\$100
1.5 kV	5	Nickel	500	34	-269	450	Yes	9294-01-W	\$100
1.5 kV	8.5	Molybdenum	500	34	-269	450	No	9294-04-W	\$100
1.5 kV	16	Copper	500	34	-269	450	No	9294-08-W	\$100

For welding instructions see page L23. For lead attachment see pages K14 - K19.



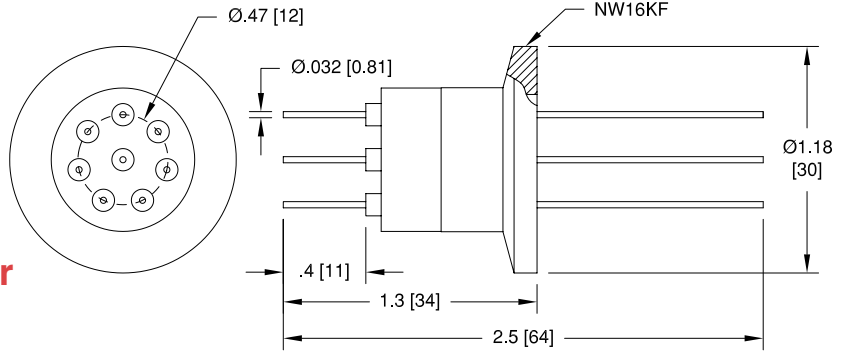

## .032 [0.81] Dia. Conductor

Eight Conductors  
Installation: NW16KF

Voltage DC	Conductor Amps	Conductor Material	Pressure @ 20°C PSIG*	Pressure @ 20°C Bar*	Temperature °C Min	Temperature °C Max	Magnetic Materials	Ceramaseal Part Number	List Price
1.5 kV	1.1	304 Stn. Stl.	0	0	-25	205	No	17008-01-KF	\$140
1.5 kV	5	Nickel	0	0	-25	205	Yes	17008-02-KF	\$140
1.5 kV	8.5	Molybdenum	0	0	-25	205	No	17008-03-KF	\$140
1.5 kV	16	Copper	0	0	-25	205	No	17008-04-KF	\$140

For flange assembly instructions see page L26. For lead attachment see pages K14 - K19. \*An overpressure ring is required for internal pressurized use from 5 to 100 psig [0.3 to 7 bar].

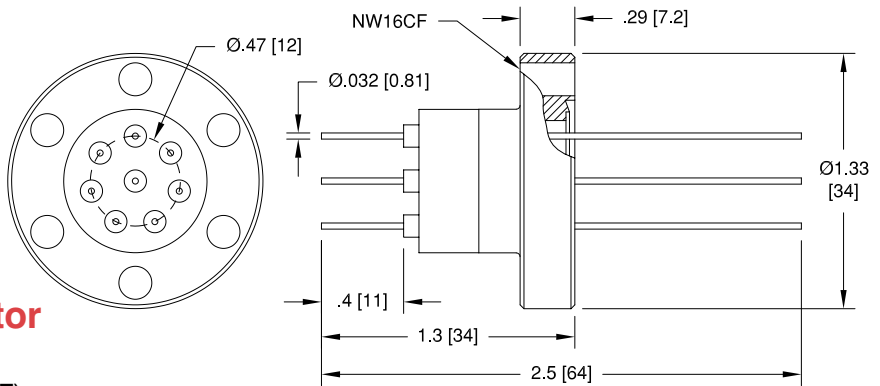
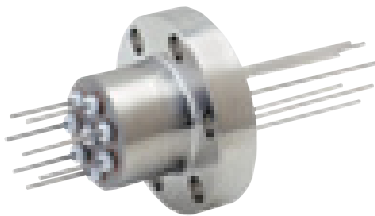

## .032 [0.81] Dia. Conductor

Eight Conductors  
Installation: 1 1/3" ConFlat (NW16CF)

Voltage DC	Conductor Amps	Conductor Material	Pressure @ 20°C PSIG	Pressure @ 20°C Bar	Temperature °C Min	Temperature °C Max	Magnetic Materials	Ceramaseal Part Number	List Price
1.5 kV	1.1	304 Stn. Stl.	500	34	-269	450	No	9340-06-CF	\$140
1.5 kV	5	Nickel	500	34	-269	450	Yes	9340-01-CF	\$140
1.5 kV	8.5	Molybdenum	500	34	-269	450	No	9340-04-CF	\$140
1.5 kV	16	Copper	500	34	-269	450	No	9340-05-CF	\$140

For flange assembly instructions see page L24 - L25. For lead attachment see pages K14 - K19.

www.ceramaseal.com



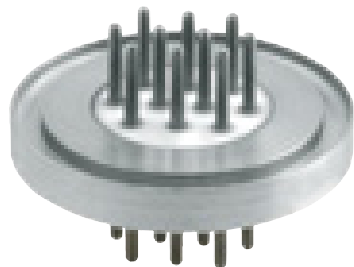

## .040 [1.0] Dia. Straight Conductor

Number of Conductors: See Table  
Installation: Weld

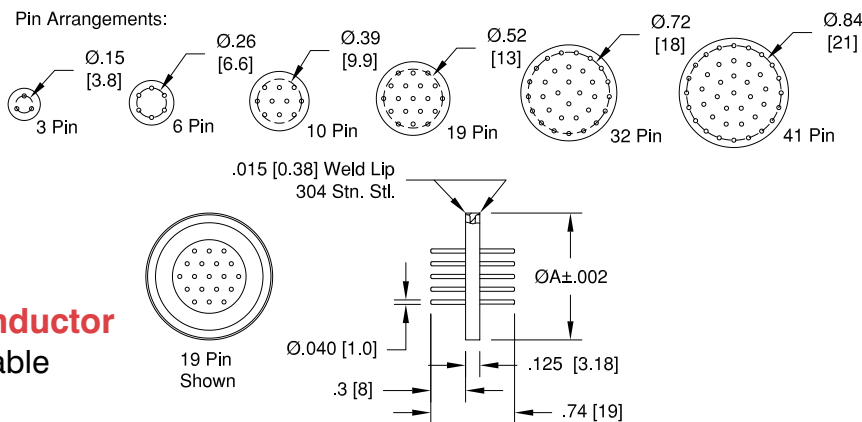

Voltage DC	Qty	Conductor Amps	Material*	Weld Diameter A	Pressure @ 20 °C PSIG	Pressure @ 20 °C Bar	Temperature °C Min	Temperature °C Max	Magnetic Materials	Ceramaseal Part Number	List Price
------------	-----	----------------	-----------	-----------------	-----------------------	----------------------	--------------------	--------------------	--------------------	------------------------	------------

1 kV	3	1	300 Series SS	0.745 [18.92]	550	38	-269	450	No	18840-01-W	\$90
1 kV	6	1	300 Series SS	0.870 [22.10]	500	34	-269	450	No	18841-01-W	\$100
1 kV	10	1	300 Series SS	0.995 [25.27]	450	31	-269	450	No	18842-01-W	\$110
1 kV	19	1	300 Series SS	1.120 [28.45]	400	28	-269	450	No	18843-01-W	\$120
1 kV	32	1	300 Series SS	1.370 [34.80]	375	26	-269	450	No	18844-01-W	\$130
1 kV	41	1	300 Series SS	1.495 [37.97]	350	24	-269	450	No	18845-01-W	\$140

For welding instructions see page L23. For lead attachment see pages K14 - K19. \*Conductors are nickel plated.



## .040 [1.0] Dia. Straight/Solder Cup Conductor

Number of Conductors: See Table  
Installation: Weld

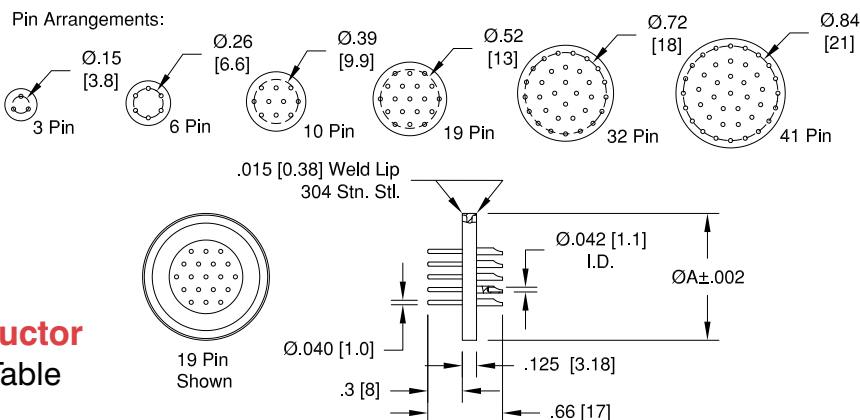

Voltage DC	Qty	Conductor Amps	Material*	Weld Diameter A	Pressure @ 20 °C PSIG	Pressure @ 20 °C Bar	Temperature °C Min	Temperature °C Max	Magnetic Materials	Ceramaseal Part Number	List Price
------------	-----	----------------	-----------	-----------------	-----------------------	----------------------	--------------------	--------------------	--------------------	------------------------	------------

1 kV	3	1	300 Series SS	0.745 [18.92]	550	38	-269	450	No	18850-01-W	\$110
1 kV	6	1	300 Series SS	0.870 [22.10]	500	34	-269	450	No	18851-01-W	\$125
1 kV	10	1	300 Series SS	0.995 [25.27]	450	31	-269	450	No	18852-01-W	\$140
1 kV	19	1	300 Series SS	1.120 [28.45]	400	28	-269	450	No	18853-01-W	\$155
1 kV	32	1	300 Series SS	1.370 [34.80]	375	26	-269	450	No	18854-01-W	\$170
1 kV	41	1	300 Series SS	1.495 [37.97]	350	24	-269	450	No	18855-01-W	\$185

For welding instructions see page L23. For lead attachment see pages K14 - K19. For soldering instructions see page L27. \*Conductors are nickel plated.

www.ceramaseal.com

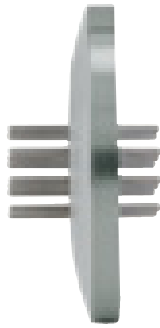

Pin Arrangements:

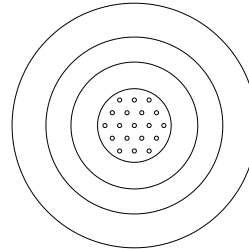
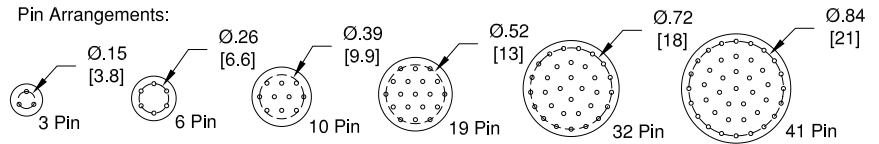

19 Pin Shown

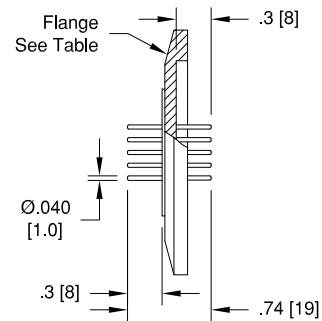

## .040 [1.0] Dia. Straight Conductor

Number of Conductors: See Table

Installation: ISO Flange

Voltage DC	Qty	Conductor Amps	Conductor Material*	Flange Size ISO	Pressure @ 20 °C PSIG**	Pressure @ 20 °C Bar**	Temperature °C Min	Temperature °C Max	Magnetic Materials	Ceramaseal Part Number	List Price
1 kV	3	1	300 Series SS	NW25KF	0	0	-25	205	No	17040-01-KF	\$130
1 kV	6	1	300 Series SS	NW40KF	0	0	-25	205	No	17041-01-KF	\$145
1 kV	10	1	300 Series SS	NW40KF	0	0	-25	205	No	17042-01-KF	\$155
1 kV	19	1	300 Series SS	NW40KF	0	0	-25	205	No	17043-01-KF	\$165
1 kV	32	1	300 Series SS	NW40KF	0	0	-25	205	No	17044-01-KF	\$175
1 kV	41	1	300 Series SS	NW50KF	0	0	-25	205	No	17045-01-KF	\$180

For flange assembly instructions see page L26. For lead attachment see pages K14 - K19. \*Conductors are nickel plated. \*\*An overpressure ring is required for internal pressurized use from 5 to 100 psig [0.3 to 7 bar].



Pin Arrangements:

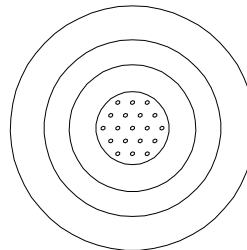
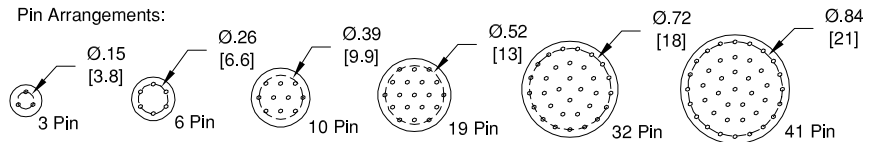

19 Pin Shown

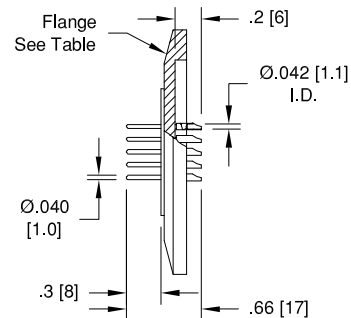

## .040 [1.0] Dia. Straight/Solder Cup Conductor

Number of Conductors: See Table

Installation: ISO Flange

Voltage DC	Qty	Conductor Amps	Conductor Material*	Flange Size ISO	Pressure @ 20 °C PSIG**	Pressure @ 20 °C Bar**	Temperature °C Min	Temperature °C Max	Magnetic Materials	Ceramaseal Part Number	List Price
1 kV	3	1	300 Series SS	NW25KF	0	0	-25	205	No	17050-01-KF	\$150
1 kV	6	1	300 Series SS	NW40KF	0	0	-25	205	No	17051-01-KF	\$170
1 kV	10	1	300 Series SS	NW40KF	0	0	-25	205	No	17052-01-KF	\$185
1 kV	19	1	300 Series SS	NW40KF	0	0	-25	205	No	17053-01-KF	\$200
1 kV	32	1	300 Series SS	NW40KF	0	0	-25	205	No	17054-01-KF	\$215
1 kV	41	1	300 Series SS	NW50KF	0	0	-25	205	No	17055-01-KF	\$235

For flange assembly instructions see page L26. For lead attachment see pages K14 - K19. For soldering instructions see page L27. \*Conductors are nickel plated. \*\*An overpressure ring is required for internal pressurized use from 5 to 100 psig [0.3 to 7 bar].

www.ceramaseal.com



**.040 [1.0] Dia.  
Straight Conductor**

Number of Conductors: See Table  
Installation: ConFlat Flange

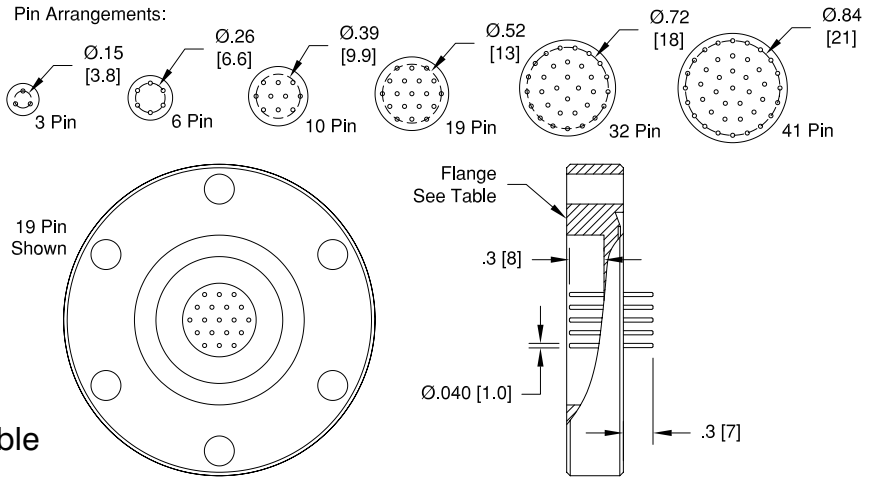

Voltage DC	Qty	Conductor Amps	Conductor Material*	Flange ConFlat	Pressure @ 20 °C PSIG	Bar	Temperature °C Min	Max	Magnetic Materials	Ceramaseal Part Number	List Price
------------	-----	----------------	---------------------	----------------	-----------------------	-----	--------------------	-----	--------------------	------------------------	------------

1 kV	3	1	300 Series SS	2 3/4" (NW35CF)	550	38	-269	450	No	17020-01-CF	\$135
1 kV	6	1	300 Series SS	2 3/4" (NW35CF)	500	34	-269	450	No	17021-01-CF	\$145
1 kV	10	1	300 Series SS	2 3/4" (NW35CF)	450	31	-269	450	No	17022-01-CF	\$155
1 kV	19	1	300 Series SS	2 3/4" (NW35CF)	400	28	-269	450	No	17023-01-CF	\$165
1 kV	32	1	300 Series SS	2 3/4" (NW35CF)	375	26	-269	450	No	17024-01-CF	\$175
1 kV	41	1	300 Series SS	3 3/8" (NW50CF)	350	24	-269	450	No	17025-01-CF	\$210

For flange assembly instructions see page L24 - L25. For lead attachment see pages K14 - K19. \*Conductors are nickel plated.



**.040 [1.0] Dia.  
Straight/Solder Cup Conductor**

Number of Conductors: See Table  
Installation: ConFlat Flange

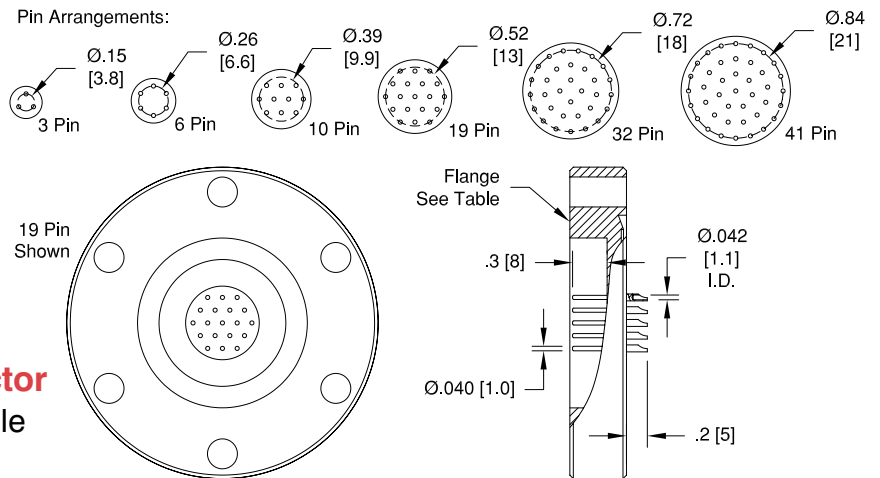

Voltage DC	Qty	Conductor Amps	Conductor Material*	Flange ConFlat	Pressure @ 20 °C PSIG	Bar	Temperature °C Min	Max	Magnetic Materials	Ceramaseal Part Number	List Price
------------	-----	----------------	---------------------	----------------	-----------------------	-----	--------------------	-----	--------------------	------------------------	------------

1 kV	3	1	300 Series SS	2 3/4" (NW35CF)	550	38	-269	450	No	17030-01-CF	\$155
1 kV	6	1	300 Series SS	2 3/4" (NW35CF)	500	34	-269	450	No	17031-01-CF	\$170
1 kV	10	1	300 Series SS	2 3/4" (NW35CF)	450	31	-269	450	No	17032-01-CF	\$185
1 kV	19	1	300 Series SS	2 3/4" (NW35CF)	400	28	-269	450	No	17033-01-CF	\$200
1 kV	32	1	300 Series SS	2 3/4" (NW35CF)	375	26	-269	450	No	17034-01-CF	\$215
1 kV	41	1	300 Series SS	3 3/8" (NW50CF)	350	24	-269	450	No	17035-01-CF	\$255

For flange assembly instructions see page L24 - L25. For lead attachment see pages K14 - K19. For soldering instructions see page L27. \*Conductors are nickel plated.



## .042 [1.1] Dia. Conductor

One Conductor

Installation: Weld or Braze

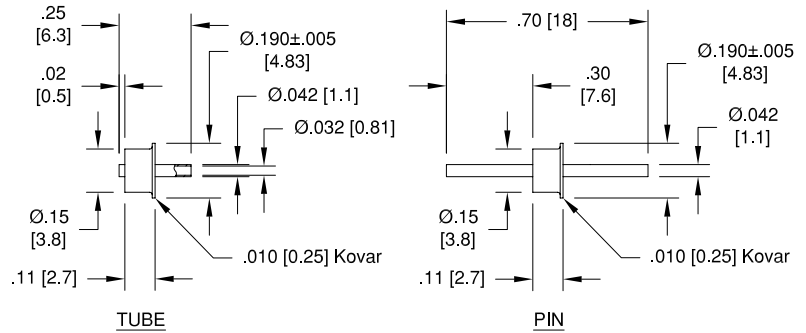

Voltage DC	Conductor		Pressure @ 20°C		Temperature °C		Magnetic Materials	Ceramaseal Part Number	List Price
	Amps	Material	PSIG	Bar	Min	Max			
500	-	Kovar Tube	2500	172	-80	450	Yes	9809-01-W	\$12
500	11.5	Molybdenum	2500	172	-80	450	Yes	9809-02-W	\$12

For welding or brazing instructions see page L23. For lead attachment see pages K14 - K19.



## .050 [1.3] Dia. Conductor

One Conductor

Installation: Weld

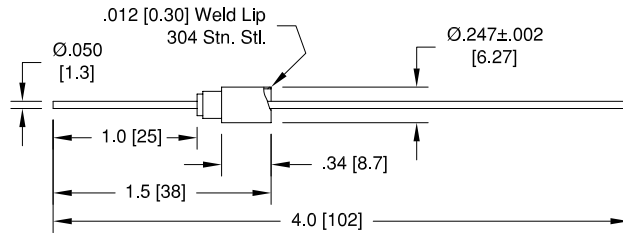

Voltage DC	Conductor		Pressure @ 20°C		Temperature °C		Magnetic Materials	Ceramaseal Part Number	List Price
	Amps	Material	PSIG	Bar	Min	Max			
2 kV	1.8	304 Stn. Stl.	3500	241	-269	450	No	7844-02-W	\$20
2 kV	8.2	Nickel	3500	241	-269	450	Yes	7844-01-W	\$20
2 kV	13.5	Molybdenum	3500	241	-269	450	No	7844-21-W	\$20
2 kV	27	Copper	3500	241	-269	450	No	7844-04-W	\$20

For welding instructions see page L23. For lead attachment see pages K14 - K19.

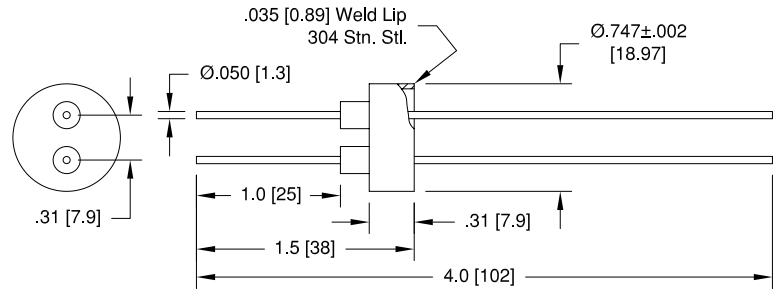
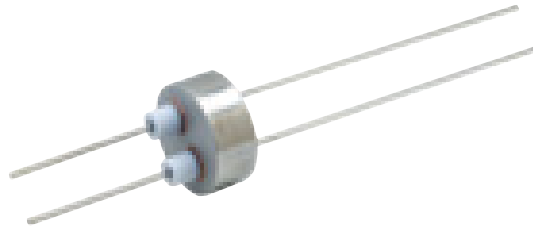

## .050 [1.3] Dia. Conductor

Two Conductors

Installation: Weld

Voltage DC	Conductor		Pressure @ 20 °C		Temperature °C		Magnetic Materials	Ceramaseal Part Number	List Price
	Amps	Material	PSIG	Bar	Min	Max			

3 kV	1.8	304 Stn. Stl.	1250	86	-269	450	No	8175-02-W	\$45
3 kV	8.2	Nickel	1250	86	-269	450	Yes	8175-01-W	\$45
3 kV	13.5	Molybdenum	1250	86	-269	450	No	8175-06-W	\$45
3 kV	27	Copper	1250	86	-269	450	No	8175-04-W	\$45

For welding instructions see page L23. For lead attachment see pages K14 - K19.

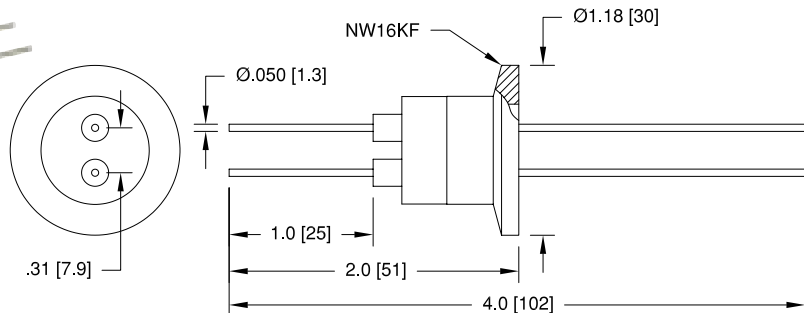
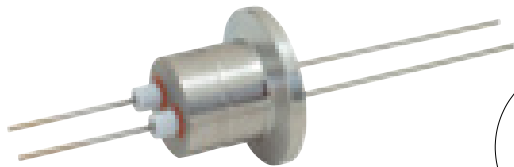

## .050 [1.3] Dia. Conductor

Two Conductors

Installation: NW16KF

Voltage DC	Conductor		Pressure @ 20 °C		Temperature °C		Magnetic Materials	Ceramaseal Part Number	List Price
	Amps	Material	PSIG*	Bar*	Min	Max			

3 kV	1.8	304 Stn. Stl.	0	0	-25	205	No	17016-01-KF	\$85
3 kV	8.2	Nickel	0	0	-25	205	Yes	17016-02-KF	\$85
3 kV	13.5	Molybdenum	0	0	-25	205	No	17016-03-KF	\$85
3 kV	27	Copper	0	0	-25	205	No	17016-04-KF	\$85

For flange assembly instructions see page L26. For lead attachment see pages K14 - K19. \*An overpressure ring is required for internal pressurized use from 5 to 100 psig [0.3 to 7 bar].

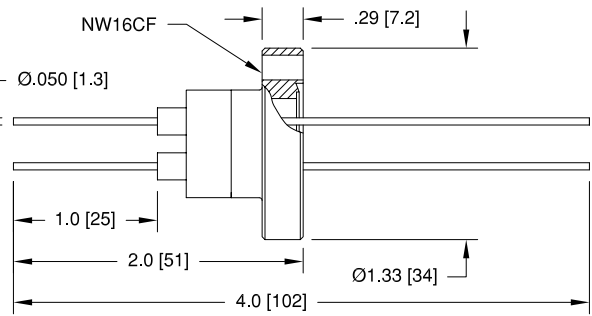
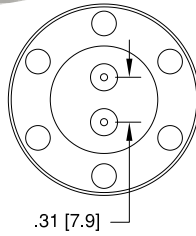
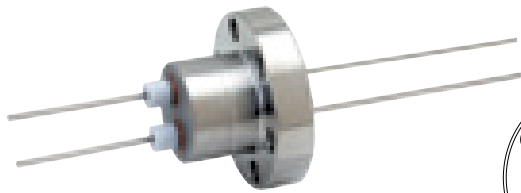

## .050 [1.3] Dia. Conductor

Two Conductors

Installation: 1 1/3" ConFlat (NW16CF)

Voltage DC	Conductor		Pressure @ 20°C		Temperature °C		Magnetic Materials	Ceramaseal Part Number	List Price
	Amps	Material	PSIG	Bar	Min	Max			
3 kV	1.8	304 Stn. Stl.	1250	86	-269	450	No	8176-05-CF	\$85
3 kV	8.2	Nickel	1250	86	-269	450	Yes	8176-01-CF	\$85
3 kV	13.5	Molybdenum	1250	86	-269	450	No	8176-09-CF	\$85
3 kV	27	Copper	1250	86	-269	450	No	8176-07-CF	\$85

For flange assembly instructions see page L24 - L25. For lead attachment see pages K14 - K19.

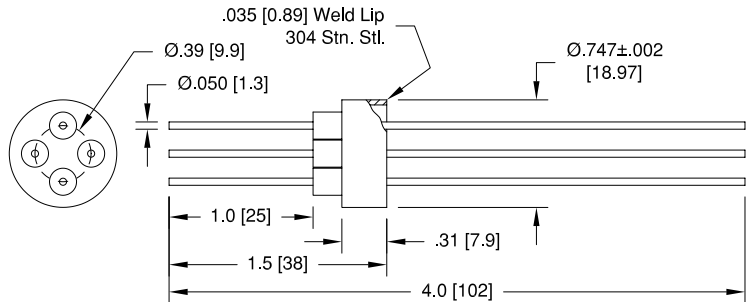
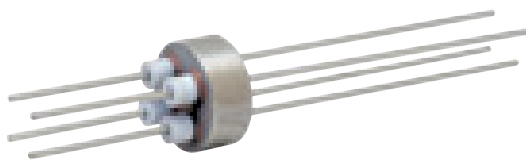

## .050 [1.3] Dia. Conductor

Four Conductors

Installation: Weld

Voltage DC	Conductor		Pressure @ 20°C		Temperature °C		Magnetic Materials	Ceramaseal Part Number	List Price
	Amps	Material	PSIG	Bar	Min	Max			
3 kV	1.8	304 Stn. Stl.	1250	86	-269	450	No	8177-02-W	\$70
3 kV	8.2	Nickel	1250	86	-269	450	Yes	8177-01-W	\$70
3 kV	13.5	Molybdenum	1250	86	-269	450	No	8177-06-W	\$70
3 kV	27	Copper	1250	86	-269	450	No	8177-04-W	\$70

For welding instructions see page L23. For lead attachment see pages K14 - K19.

www.ceramaseal.com



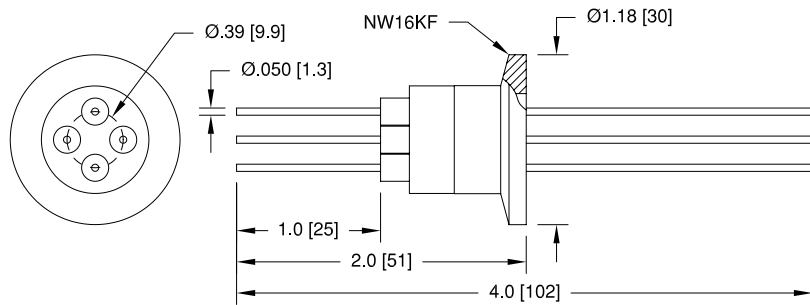
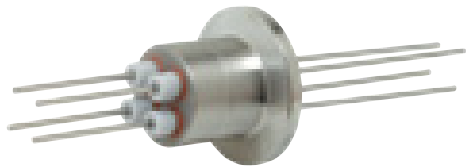

**.050 [1.3] Dia. Conductor**  
**Four Conductors**  
 Installation: NW16KF

Voltage DC	Conductor		Pressure @ 20 °C		Temperature °C		Magnetic Materials	Ceramaseal Part Number	List Price
	Amps	Material	PSIG*	Bar*	Min	Max			
3 kV	1.8	304 Stn. Stl.	0	0	-25	205	No	17017-01-KF	\$110
3 kV	8.2	Nickel	0	0	-25	205	Yes	17017-02-KF	\$110
3 kV	13.5	Molybdenum	0	0	-25	205	No	17017-03-KF	\$110
3 kV	27	Copper	0	0	-25	205	No	17017-04-KF	\$110

For flange assembly instructions see page L26. For lead attachment see pages K14 - K19. \*An overpressure ring is required for internal pressurized use from 5 to 100 psig [0.3 to 7 bar].

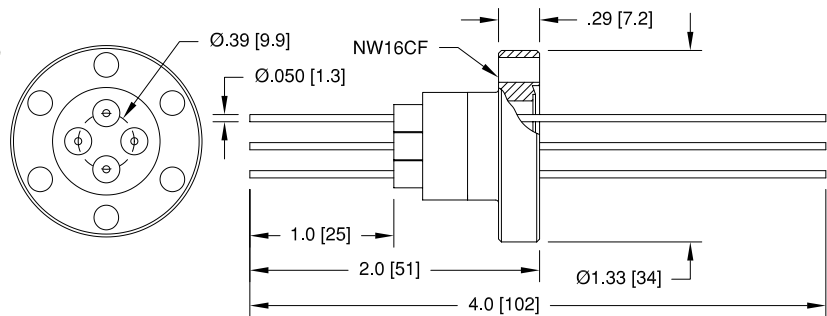
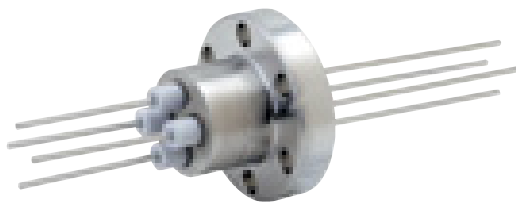

**.050 [1.3] Dia. Conductor**  
**Four Conductors**  
 Installation: 1 1/3" ConFlat (NW16CF)

Voltage DC	Conductor		Pressure @ 20 °C		Temperature °C		Magnetic Materials	Ceramaseal Part Number	List Price
	Amps	Material	PSIG	Bar	Min	Max			
3 kV	1.8	304 Stn. Stl.	1250	86	-269	450	No	8176-06-CF	\$110
3 kV	8.2	Nickel	1250	86	-269	450	Yes	8176-02-CF	\$110
3 kV	13.5	Molybdenum	1250	86	-269	450	No	8176-10-CF	\$110
3 kV	27	Copper	1250	86	-269	450	No	8176-08-CF	\$110

For flange assembly instructions see page L24 - L25. For lead attachment see pages K14 - K19.

www.ceramaseal.com

Feedthrough  
 Multipin Connector  
 Coaxial  
 Thermocouple  
 Isolator  
 Viewport  
 Pressure  
 Baseplate  
 Crystal Sensor  
 Heater  
 Accessories



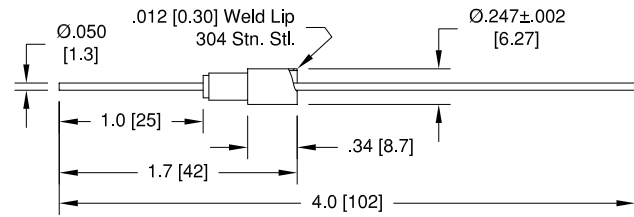

## .050 [1.3] Dia. Conductor

One Conductor

Installation: Weld

Voltage DC	Conductor		Pressure @ 20 °C		Temperature °C		Magnetic Materials	Ceramaseal Part Number	List Price
	Amps	Material	PSIG	Bar	Min	Max			
5 kV	1.8	304 Stn. Stl.	3500	241	-269	450	No	9791-04-W	\$30
5 kV	8.2	Nickel	3500	241	-269	450	Yes	9791-02-W	\$30
5 kV	13.5	Molybdenum	3500	241	-269	450	No	9791-09-W	\$30
5 kV	27	Copper	3500	241	-269	450	No	9791-08-W	\$30

For welding instructions see page L23. For lead attachment see pages K14 - K19.

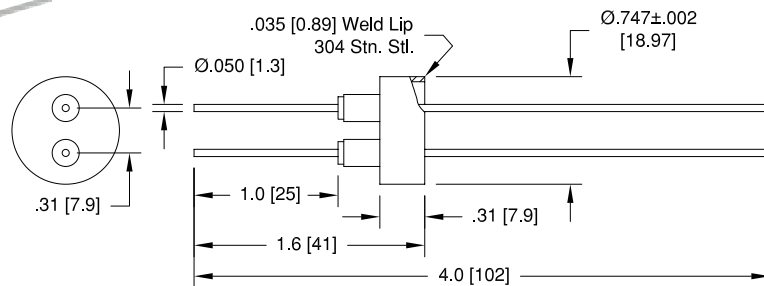
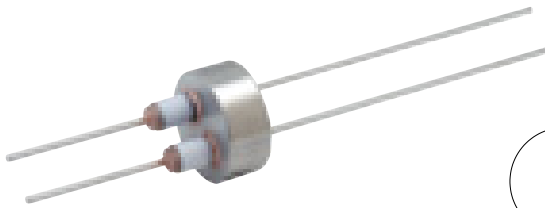

## .050 [1.3] Dia. Conductor

Two Conductors

Installation: Weld

Voltage DC	Conductor		Pressure @ 20 °C		Temperature °C		Magnetic Materials	Ceramaseal Part Number	List Price
	Amps	Material	PSIG	Bar	Min	Max			
6 kV	1.8	304 Stn. Stl.	1250	86	-269	450	No	9215-04-W	\$65
6 kV	8.2	Nickel	1250	86	-269	450	Yes	9215-02-W	\$65
6 kV	13.5	Molybdenum	1250	86	-269	450	No	9215-14-W	\$65
6 kV	27	Copper	1250	86	-269	450	No	9215-08-W	\$65

For welding instructions see page L23. For lead attachment see pages K14 - K19.

www.ceramaseal.com



**.050 [1.3] Dia. Conductor**  
Two Conductors  
Installation: NW16KF

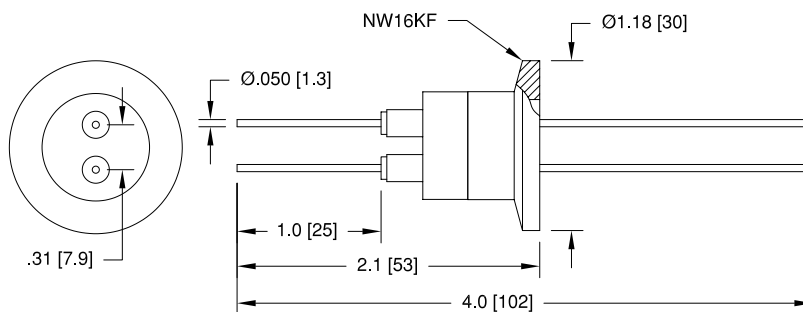

Voltage DC	Conductor Amps	Conductor Material	Pressure @ 20°C PSIG*	Pressure @ 20°C Bar*	Temperature °C Min	Temperature °C Max	Magnetic Materials	Ceramaseal Part Number	List Price
6 kV	1.8	304 Stn. Stl.	0	0	-25	205	No	17018-01-KF	\$105
6 kV	8.2	Nickel	0	0	-25	205	Yes	17018-02-KF	\$105
6 kV	13.5	Molybdenum	0	0	-25	205	No	17018-03-KF	\$105
6 kV	27	Copper	0	0	-25	205	No	17018-04-KF	\$105

For flange assembly instructions see page L26. For lead attachment see pages K14 - K19. \*An overpressure ring is required for internal pressurized use from 5 to 100 psig [0.3 to 7 bar].

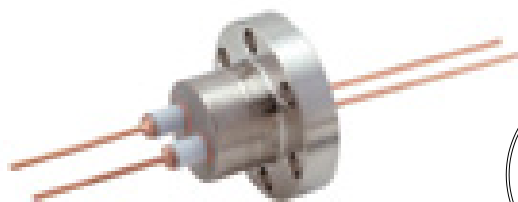

**.050 [1.3] Dia. Conductor**  
Two Conductors  
Installation: 1 1/3" ConFlat (NW16CF)

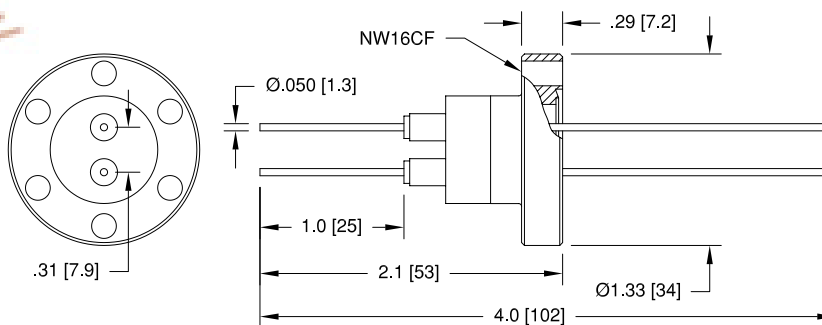

Voltage DC	Conductor Amps	Conductor Material	Pressure @ 20°C PSIG	Pressure @ 20°C Bar	Temperature °C Min	Temperature °C Max	Magnetic Materials	Ceramaseal Part Number	List Price
6 kV	1.8	304 Stn. Stl.	1250	86	-269	450	No	9871-02-CF	\$105
6 kV	8.2	Nickel	1250	86	-269	450	Yes	9871-01-CF	\$105
6 kV	13.5	Molybdenum	1250	86	-269	450	No	9871-09-CF	\$105
6 kV	27	Copper	1250	86	-269	450	No	9871-04-CF	\$105

For flange assembly instructions see page L24 - L25. For lead attachment see pages K14 - K19.

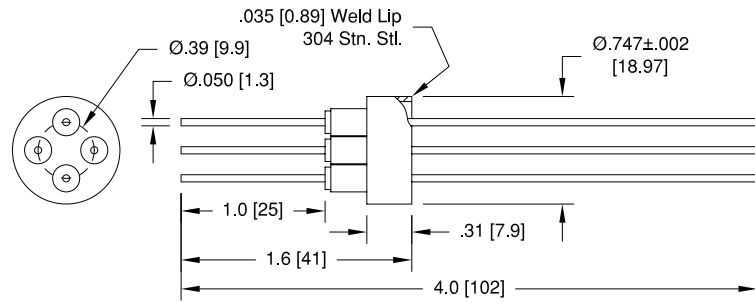
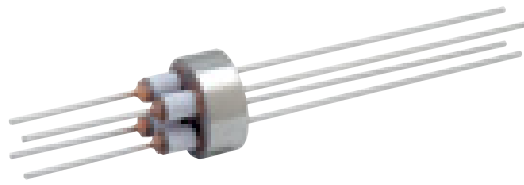

## .050 [1.3] Dia. Conductor

Four Conductors

Installation: Weld

Voltage DC	Conductor Amps	Conductor Material	Pressure @ 20°C PSIG	Pressure @ 20°C Bar	Temperature °C Min	Temperature °C Max	Magnetic Materials	Ceramaseal Part Number	List Price
6 kV	1.8	304 Stn. Stl.	1250	86	-269	450	No	9216-04-W	\$78
6 kV	8.2	Nickel	1250	86	-269	450	Yes	9216-02-W	\$78
6 kV	13.5	Molybdenum	1250	86	-269	450	No	9216-14-W	\$78
6 kV	27	Copper	1250	86	-269	450	No	9216-08-W	\$78

For welding instructions see page L23. For lead attachment see pages K14 - K19.

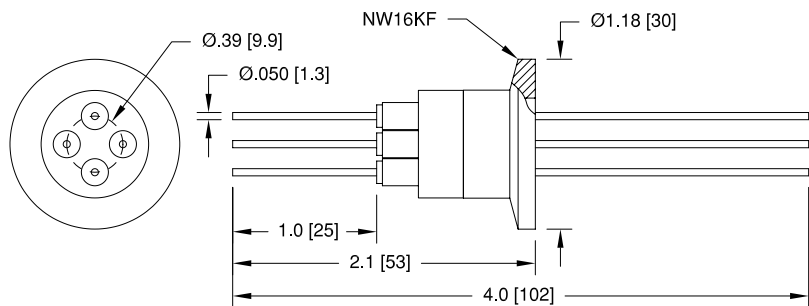

## .050 [1.3] Dia. Conductor

Four Conductors

Installation: NW16KF

Voltage DC	Conductor Amps	Conductor Material	Pressure @ 20°C PSIG*	Pressure @ 20°C Bar*	Temperature °C Min	Temperature °C Max	Magnetic Materials	Ceramaseal Part Number	List Price
6 kV	1.8	304 Stn. Stl.	0	0	-25	205	No	17019-01-KF	\$118
6 kV	8.2	Nickel	0	0	-25	205	Yes	17019-02-KF	\$118
6 kV	13.5	Molybdenum	0	0	-25	205	No	17019-03-KF	\$118
6 kV	27	Copper	0	0	-25	205	No	17019-04-KF	\$118

For flange assembly instructions see page L26. For lead attachment see pages K14 - K19. \*An overpressure ring is required for internal pressurized use from 5 to 100 psig [0.3 to 7 bar].



**.050 [1.3] Dia. Conductor**  
**Four Conductors**  
 Installation: 1 1/3" ConFlat (NW16CF)

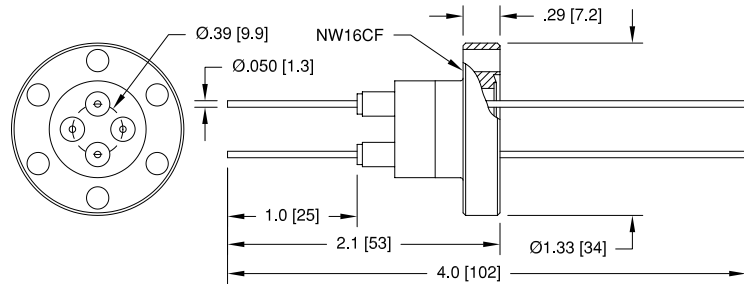

Voltage DC	Conductor		Pressure @ 20 °C		Temperature °C		Magnetic Materials	Ceramaseal Part Number	List Price
	Amps	Material	PSIG	Bar	Min	Max			
6 kV	1.8	304 Stn. Stl.	1250	86	-269	450	No	9871-06-CF	\$118
6 kV	8.2	Nickel	1250	86	-269	450	Yes	9871-05-CF	\$118
6 kV	13.5	Molybdenum	1250	86	-269	450	No	9871-10-CF	\$118
6 kV	27	Copper	1250	86	-269	450	No	9871-08-CF	\$118

For flange assembly instructions see page L24 - L25. For lead attachment see pages K14 - K19.

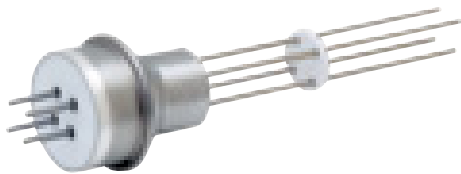

**.062 [1.6] Dia. Conductor**  
**Number of Conductors: See Table**  
 Installation: Weld

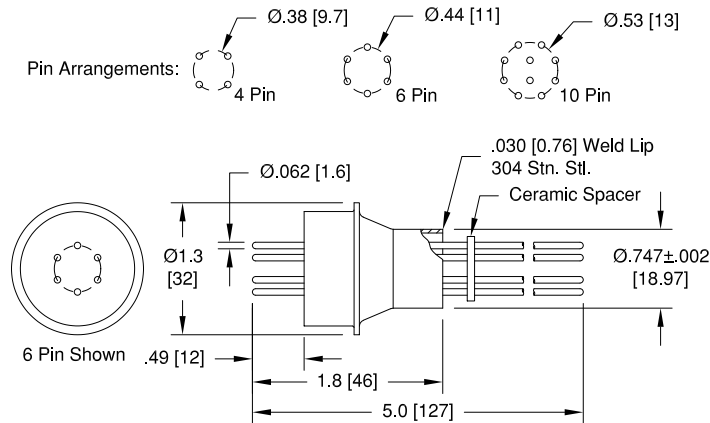

Voltage DC	Qty	Conductor		Pressure @ 20 °C		Temperature °C		Magnetic Materials	Ceramaseal Part Number	List Price
		Amps	Material	PSIG	Bar	Min	Max			
5 kV	4	4.8	Alumel	600	41	-269	450	Yes	10234-01-W	\$130
5 kV	6	4.8	Alumel	550	38	-269	450	Yes	10235-01-W	\$150
2 kV	10	4.8	Alumel	500	34	-269	450	Yes	10236-01-W	\$170

For welding instructions see page L23. For lead attachment see pages K14 - K19.

www.ceramaseal.com

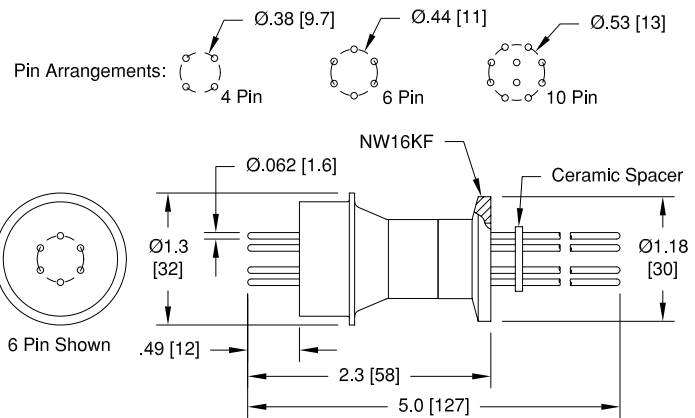
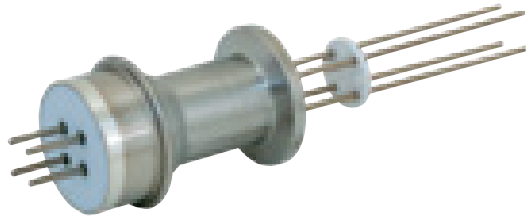

**.062 [1.6] Dia. Conductor**  
 Number of Conductors: See Table  
 Installation: NW16KF

Voltage DC	Qty	Conductor Amps	Conductor Material	Pressure @ 20 °C		Temperature °C		Magnetic Materials	Ceramaseal Part Number	List Price
				PSIG*	Bar*	Min	Max			
5 kV	4	4.8	Alumel	0	0	-25	205	Yes	10234-13-KF	\$155
5 kV	6	4.8	Alumel	0	0	-25	205	Yes	10235-13-KF	\$175
2 kV	10	4.8	Alumel	0	0	-25	205	Yes	10236-15-KF	\$195

For flange assembly instructions see page L26. For lead attachment see pages K14 - K19. \*An overpressure ring is required for internal pressurized use from 5 to 100 psig [0.3 to 7 bar].

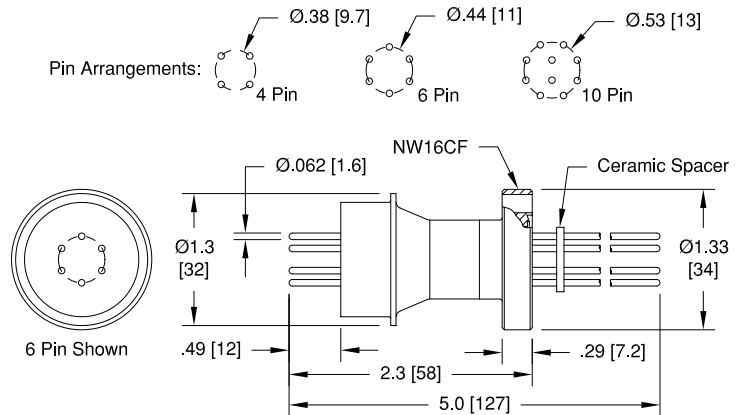

**.062 [1.6] Dia. Conductor**  
 Number of Conductors: See Table  
 Installation: 1 1/3" ConFlat (NW16CF)

Voltage DC	Qty	Conductor Amps	Conductor Material	Pressure @ 20 °C		Temperature °C		Magnetic Materials	Ceramaseal Part Number	List Price
				PSIG	Bar	Min	Max			
5 kV	4	4.8	Alumel	600	41	-269	450	Yes	10234-02-CF	\$155
5 kV	6	4.8	Alumel	550	38	-269	450	Yes	10235-02-CF	\$175
2 kV	10	4.8	Alumel	500	34	-269	450	Yes	10236-02-CF	\$195

For flange assembly instructions see page L24 - L25. For lead attachment see pages K14 - K19.

www.ceramaseal.com

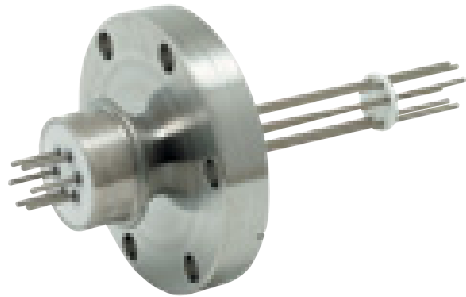

**.062 [1.6] Dia. Conductor**  
 Number of Conductors: See Table  
 Installation: 2 3/4" ConFlat (NW35CF)

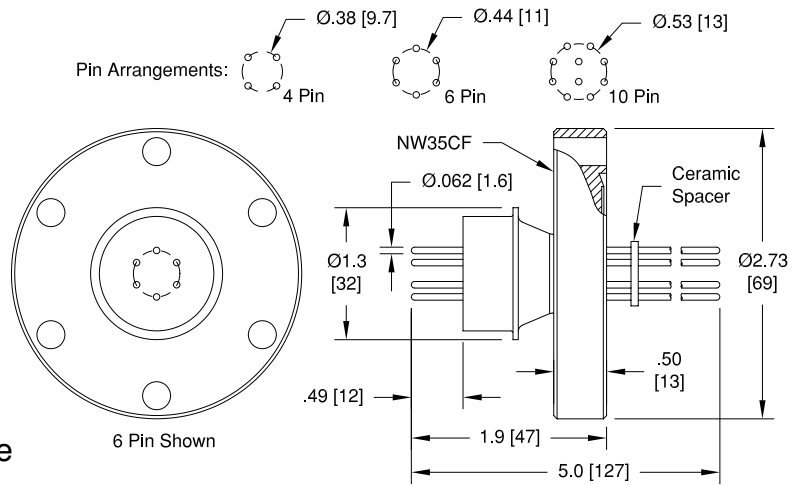

Voltage DC	Qty	Conductor		Pressure @ 20° C		Temperature ° C		Magnetic Materials	Ceramaseal Part Number	List Price
		Amps	Material	PSIG	Bar	Min	Max			
5 kV	4	4.8	Alumel	600	41	-269	450	Yes	10234-03-CF	\$175
5 kV	6	4.8	Alumel	550	38	-269	450	Yes	10235-03-CF	\$195
2 kV	10	4.8	Alumel	500	34	-269	450	Yes	10236-03-CF	\$215

For flange assembly instructions see page L24 - L25. For lead attachment see pages K14 - K19.

Feedthrough  
 Multipin Connector  
 Coaxial  
 Thermocouple  
 Isolator  
 Viewport  
 Pressure  
 Baseplate  
 Crystal Sensor  
 Heater  
 Accessories

www.ceramaseal.com

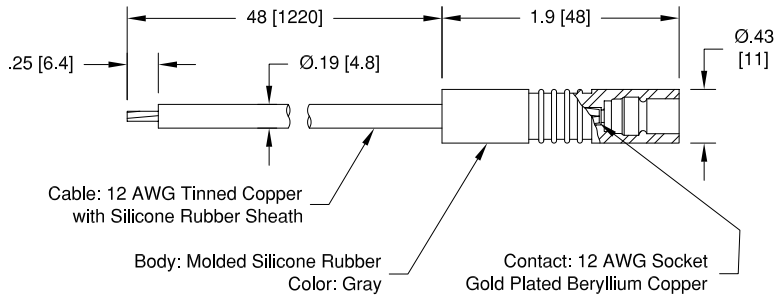

**High Voltage Plug**  
For .094 [2.4] Dia. Conductor

Voltage DC	Conductor Amps	Temperature °C Min	Temperature °C Max	Magnetic Materials	Ceramaseal Part Number	List Price
10 kV	26	-55	125	No	14418-01-A	\$45

Can be used to enhance the voltage rating of feedthroughs as indicated on the following pages.

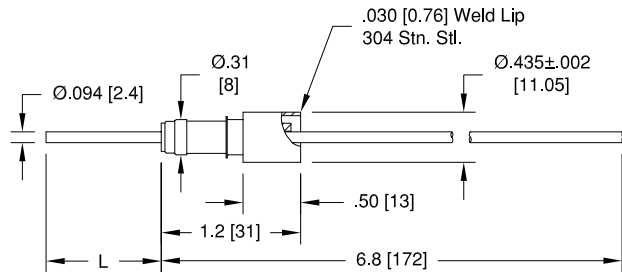

**.094 [2.4] Dia. Conductor**  
One Conductor  
Installation: Weld

Voltage DC	L	Conductor Amps	Conductor Material	Pressure @ 20 °C PSIG	Pressure @ 20 °C Bar	Temperature °C Min	Temperature °C Max	Magnetic Materials	Ceramaseal Part Number	List Price
5 kV	1.0 [25]	3.6	304 Stn. Stl.	1500	103	-269	450	No	3887-68-W	\$25
5 kV	1.0 [25]	16.5	Nickel	1500	103	-269	450	Yes	3887-51-W	\$25
5 kV	1.0 [25]	28	Molybdenum	1500	103	-269	450	No	3887-80-W	\$25
5 kV	1.0 [25]	55	Copper	1500	103	-269	450	No	3887-12-W	\$25
Specifications below apply when used with high voltage plug 14418-01-A. Sold separately. See page A22.										
10 kV	0.4 [10]	3.6	304 Stn. Stl.	1500	103	-55	125	No	3888-08-W	\$30
10 kV	0.4 [10]	16.5	Nickel	1500	103	-55	125	Yes	3888-09-W	\$30
10 kV	0.4 [10]	26	Molybdenum	1500	103	-55	125	No	3888-12-W	\$30
10 kV	0.4 [10]	26	Copper	1500	103	-55	125	No	3888-10-W	\$30

For welding instructions see page L23. For lead attachment see pages K14 - K19.

www.ceramaseal.com



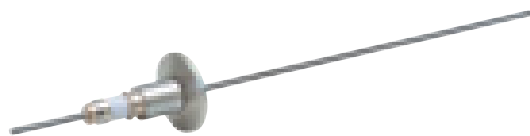

## .094 [2.4] Dia. Conductor

One Conductor

Installation: NW16KF

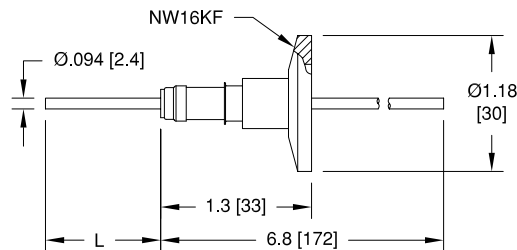

Voltage DC	L	Conductor		Pressure @ 20 °C		Temperature °C		Magnetic Materials	Ceramaseal Part Number	List Price
		Amps	Material	PSIG*	Bar*	Min	Max			
5 kV	1.0 [25]	3.6	304 Stn. Stl.	0	0	-25	205	No	17026-01-KF	\$65
5 kV	1.0 [25]	16.5	Nickel	0	0	-25	205	Yes	17026-02-KF	\$65
5 kV	1.0 [25]	28	Molybdenum	0	0	-25	205	No	17026-03-KF	\$65
5 kV	1.0 [25]	55	Copper	0	0	-25	205	No	17026-04-KF	\$65
Specifications below apply when used with high voltage plug 14418-01-A. Sold separately. See page A22.										
10 kV	0.4 [10]	3.6	304 Stn. Stl.	0	0	-25	125	No	17026-05-KF	\$70
10 kV	0.4 [10]	16.5	Nickel	0	0	-25	125	Yes	17026-06-KF	\$70
10 kV	0.4 [10]	26	Molybdenum	0	0	-25	125	No	17026-07-KF	\$70
10 kV	0.4 [10]	26	Copper	0	0	-25	125	No	17026-08-KF	\$70

For flange assembly instructions see page L26. For lead attachment see pages K14 - K19. \*An overpressure ring is required for internal pressurized use from 5 to 100 psig [0.3 to 7 bar].



## .094 [2.4] Dia. Conductor

One Conductor

Installation: 1 1/3" ConFlat (NW16CF)

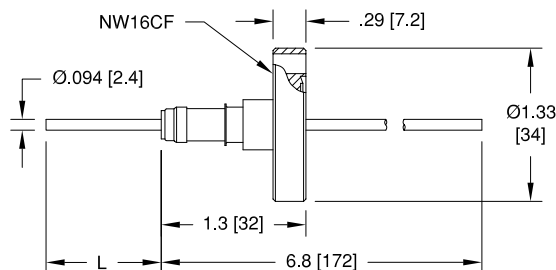

Voltage DC	L	Conductor		Pressure @ 20 °C		Temperature °C		Magnetic Materials	Ceramaseal Part Number	List Price
		Amps	Material	PSIG	Bar	Min	Max			
5 kV	1.0 [25]	3.6	304 Stn. Stl.	1500	103	-269	450	No	19542-05-CF	\$65
5 kV	1.0 [25]	16.5	Nickel	1500	103	-269	450	Yes	19542-01-CF	\$65
5 kV	1.0 [25]	28	Molybdenum	1500	103	-269	450	No	19542-06-CF	\$65
5 kV	1.0 [25]	55	Copper	1500	103	-269	450	No	19542-02-CF	\$65
Specifications below apply when used with high voltage plug 14418-01-A. Sold separately. See page A22.										
10 kV	0.4 [10]	3.6	304 Stn. Stl.	1500	103	-55	125	No	19542-07-CF	\$70
10 kV	0.4 [10]	16.5	Nickel	1500	103	-55	125	Yes	19542-03-CF	\$70
10 kV	0.4 [10]	26	Molybdenum	1500	103	-55	125	No	19542-08-CF	\$70
10 kV	0.4 [10]	26	Copper	1500	103	-55	125	No	19542-04-CF	\$70

For flange assembly instructions see page L24 - L25. For lead attachment see pages K14 - K19.

www.ceramaseal.com

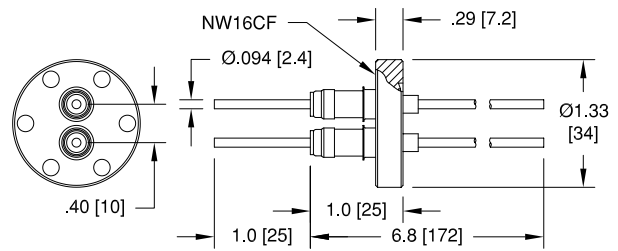
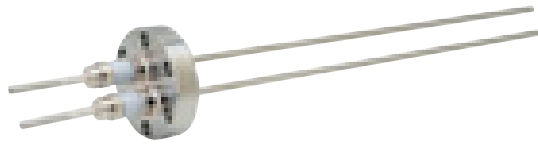

## .094 [2.4] Dia. Conductor

Two Conductors

Installation: 1 1/3" ConFlat (NW16CF)

Voltage DC	Conductor		Pressure @ 20 °C		Temperature °C		Magnetic Materials	Ceramaseal Part Number	List Price
	Amps	Material	PSIG	Bar	Min	Max			
5 kV	3.6	304 Stn. Stl.	1500	103	-269	450	No	9545-07-CF	\$110
5 kV	16.5	Nickel	1500	103	-269	450	Yes	9545-01-CF	\$110
5 kV	28	Molybdenum	1500	103	-269	450	No	9545-08-CF	\$110
5 kV	55	Copper	1500	103	-269	450	No	9545-02-CF	\$110

For flange assembly instructions see page L24 - L25. For lead attachment see pages K14 - K19.

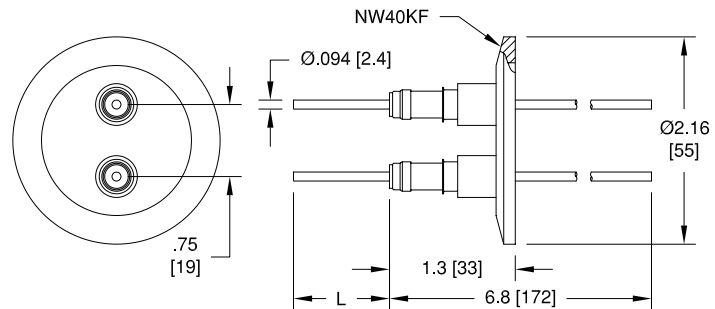

## .094 [2.4] Dia. Conductor

Two Conductors

Installation: NW40KF

Voltage DC	L	Conductor		Pressure @ 20 °C		Temperature °C		Magnetic Materials	Ceramaseal Part Number	List Price
		Amps	Material	PSIG*	Bar*	Min	Max			
5 kV	1.0 [25]	3.6	304 Stn. Stl.	0	0	-25	205	No	17027-01-KF	\$120
5 kV	1.0 [25]	16.5	Nickel	0	0	-25	205	Yes	17027-02-KF	\$120
5 kV	1.0 [25]	28	Molybdenum	0	0	-25	205	No	17027-03-KF	\$120
5 kV	1.0 [25]	55	Copper	0	0	-25	205	No	17027-04-KF	\$120

Specifications below apply when used with high voltage plug 14418-01-A. Sold separately. See page A22.

10 kV	0.4 [10]	3.6	304 Stn. Stl.	0	0	-25	125	No	17027-05-KF	\$125
10 kV	0.4 [10]	16.5	Nickel	0	0	-25	125	Yes	17027-06-KF	\$125
10 kV	0.4 [10]	26	Molybdenum	0	0	-25	125	No	17027-07-KF	\$125
10 kV	0.4 [10]	26	Copper	0	0	-25	125	No	17027-08-KF	\$125

For flange assembly instructions see page L26. For lead attachment see pages K14 - K19. \*An overpressure ring is required for internal pressurized use from 5 to 100 psig [0.3 to 7 bar].

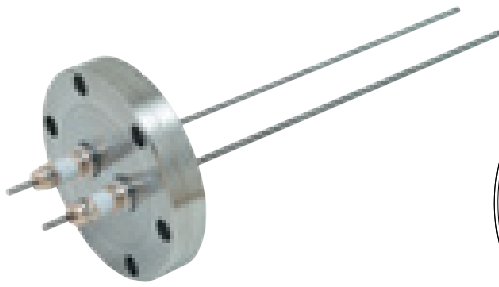

## .094 [2.4] Dia. Conductor

Two Conductors

Installation: 2 3/4" ConFlat (NW35CF)

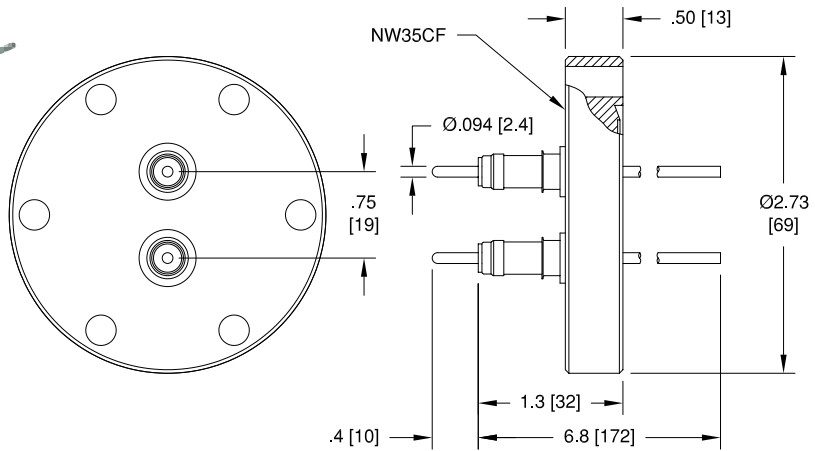

Voltage DC*	Conductor Amps	Conductor Material	Pressure @ 20°C PSIG	Pressure @ 20°C Bar	Temperature °C Min*	Temperature °C Max*	Magnetic Materials	Ceramaseal Part Number	List Price
10 kV	3.6	304 Stn. Stl.	1500	103	-55	125	No	17060-05-CF	\$125
10 kV	16.5	Nickel	1500	103	-55	125	Yes	17060-06-CF	\$125
10 kV	26*	Molybdenum	1500	103	-55	125	No	17060-07-CF	\$125
10 kV	26*	Copper	1500	103	-55	125	No	17060-08-CF	\$125

For flange assembly instructions see page L24 - L25. For lead attachment see pages K14 - K19. \*Specifications apply when used with high voltage plug 14418-01-A. Sold separately. See page A22.

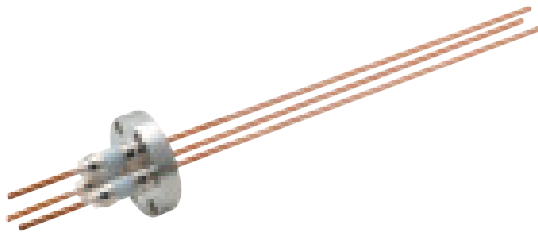

## .094 [2.4] Dia. Conductor

Three Conductors

Installation: 1 1/3" ConFlat (NW16CF)

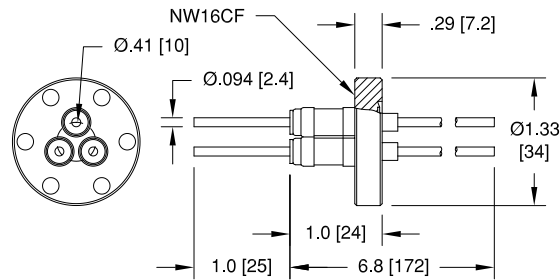

Voltage DC	Conductor Amps	Conductor Material	Pressure @ 20°C PSIG	Pressure @ 20°C Bar	Temperature °C Min	Temperature °C Max	Magnetic Materials	Ceramaseal Part Number	List Price
5 kV	3.6	304 Stn. Stl.	1500	103	-269	450	No	6404-07-CF	\$138
5 kV	16.5	Nickel	1500	103	-269	450	Yes	6404-03-CF	\$138
5 kV	28	Molybdenum	1500	103	-269	450	No	6404-08-CF	\$138
5 kV	55	Copper	1500	103	-269	450	No	6404-02-CF	\$138

For flange assembly instructions see page L24 - L25. For lead attachment see pages K14 - K19.

Feedthrough  
 Multipin Connector  
 Coaxial  
 Thermocouple  
 Isolator  
 Viewport  
 Pressure  
 Baseplate  
 Crystal Sensor  
 Heater  
 Accessories

www.ceramaseal.com

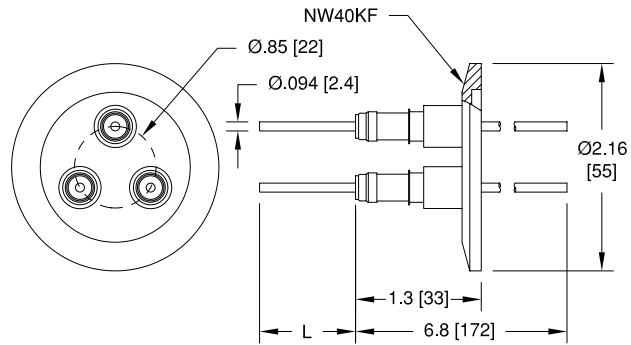
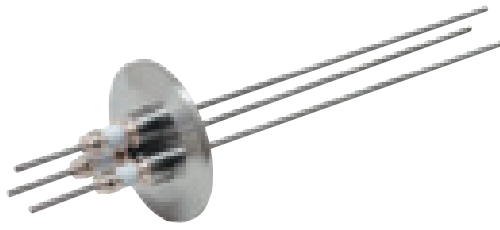

## .094 [2.4] Dia. Conductor

Three Conductors

Installation: NW40KF

Voltage DC	L	Conductor		Pressure @ 20 °C		Temperature °C		Magnetic Materials	Ceramaseal Part Number	List Price
		Amps	Material	PSIG*	Bar*	Min	Max			
5 kV	1.0 [25]	3.6	304 Stn. Stl.	0	0	-25	205	No	17067-01-KF	\$135
5 kV	1.0 [25]	16.5	Nickel	0	0	-25	205	Yes	17067-02-KF	\$135
5 kV	1.0 [25]	28	Molybdenum	0	0	-25	205	No	17067-03-KF	\$135
5 kV	1.0 [25]	55	Copper	0	0	-25	205	No	17067-04-KF	\$135
Specifications below apply when used with high voltage plug 14418-01-A. Sold separately. See page A22.										
10 kV	0.4 [10]	3.6	304 Stn. Stl.	0	0	-25	125	No	17067-05-KF	\$145
10 kV	0.4 [10]	16.5	Nickel	0	0	-25	125	Yes	17067-06-KF	\$145
10 kV	0.4 [10]	26	Molybdenum	0	0	-25	125	No	17067-07-KF	\$145
10 kV	0.4 [10]	26	Copper	0	0	-25	125	No	17067-08-KF	\$145

For flange assembly instructions see page L26. For lead attachment see pages K14 - K19. \*An overpressure ring is required for internal pressurized use from 5 to 100 psig [0.3 to 7 bar].

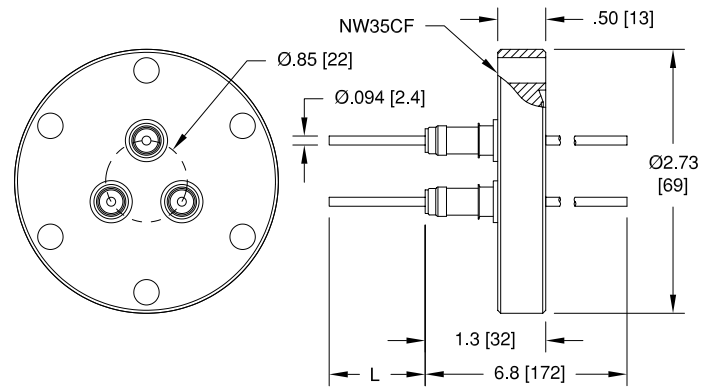
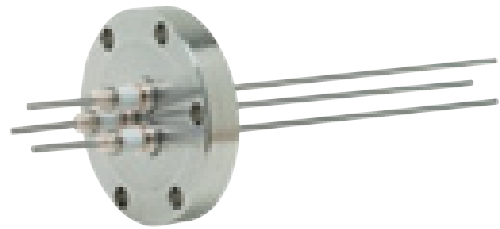

## .094 [2.4] Dia. Conductor

Three Conductors

Installation: 2 3/4" ConFlat (NW35CF)

Voltage DC	L	Conductor		Pressure @ 20 °C		Temperature °C		Magnetic Materials	Ceramaseal Part Number	List Price
		Amps	Material	PSIG	Bar	Min	Max			
5 kV	1.0 [25]	3.6	304 Stn. Stl.	1500	103	-269	450	No	17064-01-CF	\$135
5 kV	1.0 [25]	16.5	Nickel	1500	103	-269	450	Yes	17064-02-CF	\$135
5 kV	1.0 [25]	28	Molybdenum	1500	103	-269	450	No	17064-03-CF	\$135
5 kV	1.0 [25]	55	Copper	1500	103	-269	450	No	17064-04-CF	\$135
Specifications below apply when used with high voltage plug 14418-01-A. Sold separately. See page A22.										
10 kV	0.4 [10]	3.6	304 Stn. Stl.	1500	103	-55	125	No	17064-05-CF	\$145
10 kV	0.4 [10]	16.5	Nickel	1500	103	-55	125	Yes	17064-06-CF	\$145
10 kV	0.4 [10]	26	Molybdenum	1500	103	-55	125	No	17064-07-CF	\$145
10 kV	0.4 [10]	26	Copper	1500	103	-55	125	No	17064-08-CF	\$145

For flange assembly instructions see page L24 - L25. For lead attachment see pages K14 - K19.

www.ceramaseal.com